

TPRO 20

CE EN60974-7



| CODE | ↔ | | ↖ | ⚡ |
|-----------|-----|-------|-----------|-------------|
| HV2410-00 | 4 m | 12.5' | dual | TSK 50-1/4G |
| HV2810-00 | 8 m | 25' | dual | |
| HU2410-00 | 4 m | 12.5' | dual flex | |
| HU2810-00 | 8 m | 25' | dual flex | |

| TECHNICAL DATA | |
|----------------|-----------------------------|
| | TPRO 20 |
| | 0,85 kg 1.87 lb |
| | 113 |
| | Argon |
| | 0,5 ÷ 3,2 mm .020" ÷ 1/8" |
| | 250A DC - 220A AC |
| | 4 bar |
| | 1,5 l/min |

| CODE | | | |
|------|--------|--|--------------------------------|
| 4 | TQ0001 | | insulator 10 |
| 5 | TG0020 | | tig 20 torch head 1 |
| 6 | TG0220 | | tig 20 flex torch head 1 |
| 7 | BW0063 | | back cap 147,5 mm 10 |
| 7 | EA0129 | | O-ring Ø 4,5x2 mm 10 |
| 8 | TT0183 | | kit Tpro Dual 1 |
| 9 | TT0184 | | kit Tpro Multi 1 |
| 10 | BW0304 | | reduction 1 |
| 10 | BW0310 | | cable joint 1 |
| 10 | EA0329 | | screw 50 |
| 10 | TP0139 | | Tpro handle 1 |
| 11 | TH1232 | | cable assembly - 4 m / 12.5' 1 |
| 11 | TH1233 | | cable assembly - 8 m / 25' 1 |
| 12 | TH1012 | | power cable - 4 m / 12.5' 1 |
| 12 | TH1013 | | power cable - 8 m / 25' 1 |
| 15 | CX0080 | | TSK 50 - quick plug 1 |

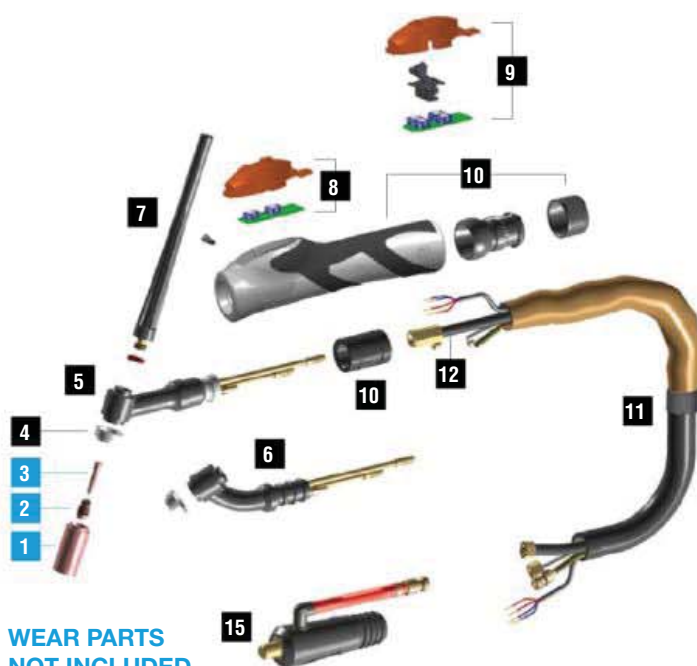

WEAR PARTS NOT INCLUDED

Starter kits page 360
Wear parts page 361

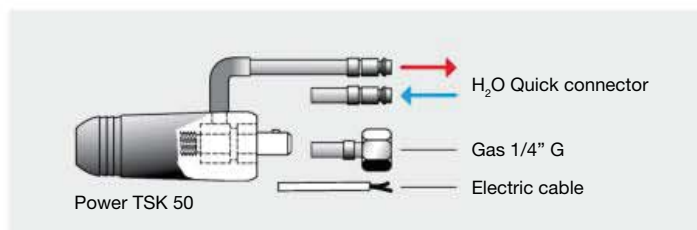

SERIES 9 - 20 - 25 - SUPER 20 WEAR PARTS



STANDARD

| | CODE | | Gr | Ø | | REF | |
|---|-----------|--|----|---------------|-------|--------|----|
| 1 | TC0012 | | 4 | 6,4 mm 1/4" | 30 mm | 13N08 | 10 |
| 1 | TC0013 | | 5 | 8 mm 5/16" | 30 mm | 13N09 | 10 |
| 1 | TC0014 | | 6 | 9,8 mm 3/8" | 30 mm | 13N10 | 10 |
| 1 | TC0015 | | 7 | 11,2 mm 7/16" | 30 mm | 13N11 | 10 |
| 1 | TC0016 | | 8 | 12,7 mm 1/2" | 30 mm | 13N12 | 10 |
| 1 | TC0017 | | 10 | 15,7 mm 5/8" | 30 mm | 13N13 | 10 |
| 1 | TC0096 | | 4 | 6,5 mm 1/4" | 48 mm | 796F71 | 10 |
| 1 | TC0097 | | 5 | 8 mm 5/16" | 48 mm | 796F72 | 10 |
| 1 | TC0098 | | 6 | 9,5 mm 3/8" | 48 mm | 796F73 | 10 |
| 1 | TC0101 | | 4 | 6,5 mm 1/4" | 63 mm | 796F75 | 10 |
| 1 | TC0102 | | 5 | 8 mm 5/16" | 63 mm | 796F76 | 10 |
| 1 | TC0103 | | 4 | 6,5 mm 1/4" | 89 mm | 796F79 | 10 |
| 2 | TE0003-05 | | | 0,5 mm .020" | 21 mm | 13N25 | 10 |
| 2 | TE0003-10 | | | 1,0 mm .040" | 21 mm | 13N26 | 10 |
| 2 | TE0003-16 | | | 1,6 mm 1/16" | 21 mm | 13N27 | 10 |
| 2 | TE0003-20 | | | 2,0 mm 5/64" | 21 mm | - | 10 |
| 2 | TE0003-24 | | | 2,4 mm 3/32" | 21 mm | 13N28 | 10 |
| 2 | TE0003-32 | | | 3,2 mm 1/8" | 21 mm | 13N29 | 10 |

| | CODE | | Gr | Ø | | REF | |
|---|-----------|--|----|--------------|----------|--------|----|
| 3 | TD0003-05 | | | 0,5 mm .020" | 25 mm | 13N20 | 10 |
| 3 | TD0003-10 | | | 1,0 mm .040" | 25 mm | 13N21 | 10 |
| 3 | TD0003-16 | | | 1,6 mm 1/16" | 25 mm | 13N22 | 10 |
| 3 | TD0003-20 | | | 2,0 mm 5/64" | 25 mm | - | 10 |
| 3 | TD0003-24 | | | 2,4 mm 3/32" | 25 mm | 13N23 | 10 |
| 3 | TD0003-32 | | | 3,2 mm 1/8" | 25 mm | 13N24 | 10 |
| 4 | TQ0001 | | | | | 598882 | 10 |
| 7 | BW0063 | | | | 147,5 mm | 41V24 | 10 |
| 7 | BW0064 | | | | 53 mm | 41V35 | 10 |
| 7 | BW0065 | | | | 17,5 mm | 41V33 | 10 |
| 7 | EA0129 | | | | | | 10 |

GAS LENS

| | CODE | | Gr | Ø | | REF | |
|---|-----------|--|----|---------------|----------|--------|----|
| 1 | TC0041 | | 4 | 6,4 mm 1/4" | 25,5 mm | 53N58 | 10 |
| 1 | TC0042 | | 5 | 8 mm 5/16" | 25,5 mm | 53N59 | 10 |
| 1 | TC0043 | | 6 | 9,8 mm 3/8" | 25,5 mm | 53N60 | 10 |
| 1 | TC0044 | | 7 | 11,2 mm 7/16" | 25,5 mm | 53N61 | 10 |
| 1 | TC0045 | | 8 | 12,7 mm 1/2" | 25,5 mm | 53N61S | 10 |
| 2 | TE0005-05 | | | 0,5 mm .020" | 22 mm | 45V41 | 10 |
| 2 | TE0005-10 | | | 1,0 mm .040" | 22 mm | 45V42 | 10 |
| 2 | TE0005-16 | | | 1,6 mm 1/16" | 22 mm | 45V43 | 10 |
| 2 | TE0005-20 | | | 2,0 mm 5/64" | 22 mm | - | 10 |
| 2 | TE0005-24 | | | 2,4 mm 3/32" | 22 mm | 45V44 | 10 |
| 2 | TE0005-32 | | | 3,2 mm 1/8" | 22 mm | 45V45 | 10 |
| 2 | TE0025-16 | | | 1,6 mm 1/16" | 22 mm | - | 10 |
| 2 | TE0025-20 | | | 2,0 mm 5/64" | 22 mm | - | 10 |
| 2 | TE0025-24 | | | 2,4 mm 3/32" | 22 mm | - | 10 |
| 2 | TE0025-32 | | | 3,2 mm 1/8" | 22 mm | - | 10 |
| 3 | TD0003-05 | | | 0,5 mm .020" | 25 mm | 13N20 | 10 |
| 3 | TD0003-10 | | | 1,0 mm .040" | 25 mm | 13N21 | 10 |
| 3 | TD0003-16 | | | 1,6 mm 1/16" | 25 mm | 13N22 | 10 |
| 3 | TD0003-20 | | | 2,0 mm 5/64" | 25 mm | - | 10 |
| 3 | TD0003-24 | | | 2,4 mm 3/32" | 25 mm | 13N23 | 10 |
| 3 | TD0003-32 | | | 3,2 mm 1/8" | 25 mm | 13N24 | 10 |
| 4 | TQ0001 | | | | | 598882 | 10 |
| 7 | BW0063 | | | | 147,5 mm | 41V24 | 10 |
| 7 | BW0064 | | | | 53 mm | 41V35 | 10 |
| 7 | BW0065 | | | | 17,5 mm | 41V33 | 10 |
| 7 | EA0129 | | | | | | 10 |

GAS LENS XL (JUMBO)

| | CODE | | Gr | Ø | | REF | |
|---|-----------|--|----|--------------|----------|---------|----|
| 1 | TC0118 | | 8 | 12,7 mm 1/2" | 48 mm | 57N74 | 10 |
| 1 | TC0119 | | 10 | 15,7 mm 5/8" | 48 mm | 53N88 | 10 |
| 1 | TC0120 | | 12 | 19,5 mm 3/4" | 48 mm | 53N87 | 10 |
| 2 | TE0088-16 | | | 1,6 mm 1/16" | 40 mm | 45V116S | 2 |
| 2 | TE0088-24 | | | 2,4 mm 3/32" | 40 mm | 45V64S | 2 |
| 2 | TE0088-32 | | | 3,2 mm 1/8" | 40 mm | - | 2 |
| 3 | TD0088-16 | | | 1,6 mm 1/16" | 40 mm | 13N22L | 10 |
| 3 | TD0088-20 | | | 2,0 mm 5/64" | 40 mm | - | 10 |
| 3 | TD0088-24 | | | 2,4 mm 3/32" | 40 mm | 13N23L | 10 |
| 3 | TD0088-32 | | | 3,2 mm 1/8" | 40 mm | 13N24L | 10 |
| 4 | TQ0026 | | | | | 54N6320 | 10 |
| 7 | BW0063 | | | | 147,5 mm | 41V24 | 10 |
| 7 | BW0064 | | | | 53 mm | 41V35 | 10 |
| 7 | BW0065 | | | | 17,5 mm | 41V33 | 10 |
| 7 | EA0129 | | | | | | 10 |

Gas protection flow is usually guttered by a STANDARD ceramic nozzle (picture 1). Such flow is affected by turbulences of head torch which are caused by the inlet pressure. In order to assure a uniform gas distribution, above all in stainless steel, titanium and aluminium alloys welding, we suggest the use of GAS LENS spare parts. The electrode holder equipped with a gas lens net, uniform the flow (picture 2) and aid to save the protection gas. Where permitted by external dimensions, it is recommended the JUMBO version which increases the protected surface with advantage for welding quality (picture 3).

