





B400

CE EN 60974-7



CODE	↔		
F16704.5	4,5 m	15'	 EURO BD

TECHNICAL DATA		
	B400	
V PEAK	113	
	0,8 ÷ 2,4 mm	.030" ÷ 3/32"
X 60%	400A CO2 - 350A Mix	

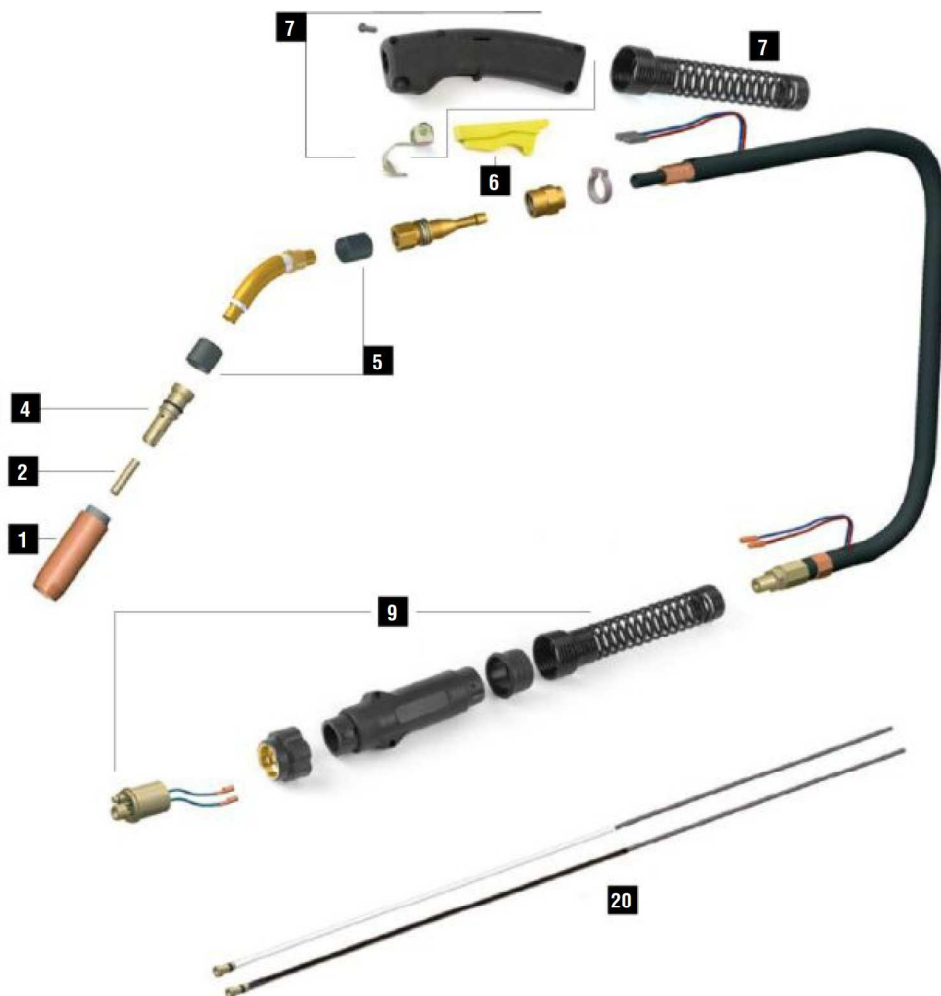

	CODE				Ø			REF		
1	MC0420		• •	brass nozzle	19 mm	3/4"	74,5 mm 2-11/16"	4491	10	
1	MC0421		• •	copper nozzle	19 mm	3/4"	74,5 mm 2-11/16"	4591	10	
1	MC0422		• •	brass nozzle	14 mm	9/16"	74,5 mm 2-11/16"	4492	10	
1	MC0423		• •	copper nozzle	14 mm	9/16"	74,5 mm 2-11/16"	4592	10	
2	MD0214-06		•	Cu	0,6 mm	.023"	50,9 mm 2"	1597	20	
2	MD0214-08		•	Cu	0,8 mm	.030"	50,9 mm 2"	1588	20	
2	MD0214-09		•	Cu	0,9 mm	.035"	50,9 mm 2"	1589	20	
2	MD0214-10		•	Cu	1,0 mm	.040"	50,9 mm 2"	1596	20	
2	MD0214-12		•	Cu	1,2 mm	.045"	50,9 mm 2"	1590	20	
2	MD0214-14		•	Cu	1,4 mm	.052"	50,9 mm 2"	1598	20	
2	MD0214-16		•	Cu	1,6 mm	1/16"	50,9 mm 2"	1591	20	
2	MD0214-20		•	Cu	2,0 mm	5/64"	50,9 mm 2"	1592	20	
2	MD0214-24		•	Cu	2,4 mm	3/32"	50,9 mm 2"	1593	20	
2	MD0214-28		•	Cu	2,8 mm	7/64"	50,9 mm 2"	1594	20	
2	MD0214-32		•	Cu	3,2 mm		50,9 mm 2"	1595	20	
2	MD0215-06			•	Cu	0,6 mm	.023"	32,4 mm 1"-1/4	7497	20
2	MD0215-08			•	Cu	0,8 mm	.030"	32,4 mm 1"-1/4	7488	20
2	MD0215-09			•	Cu	0,9 mm	.035"	32,4 mm 1"-1/4	7489	20
2	MD0215-10	•		Cu	1,0 mm	.040"	32,4 mm 1"-1/4	7496	20	
2	MD0215-12	•		Cu	1,2 mm	.045"	32,4 mm 1"-1/4	7490	20	
2	MD0215-14	•		Cu	1,4 mm	.052"	32,4 mm 1"-1/4	7498	20	
2	MD0215-16	•		Cu	1,6 mm	1/16"	32,4 mm 1"-1/4	7491	20	
2	MD0215-20	•		Cu	2,0 mm	5/64"	32,4 mm 1"-1/4	7492	20	
2	MD0215-24	•		Cu	2,4 mm	3/32"	32,4 mm 1"-1/4	7493	20	
2	MD0215-28	•		Cu	2,8 mm	7/64"	32,4 mm 1"-1/4	7494	20	
4	ME0111		•	brass		1/4 NPT	56,5 mm 2"-1/4	4435	10	
4	ME0112		•	brass		1/4 NPT	56,5 mm 2"-1/4	4635	10	
20	GM0276			black liner	0,6 ÷ 0,8 mm	.023" ÷ .030"	4,5 m 15'	43015	1	
20	GM0280			black liner	0,9 ÷ 1,2 mm	.035" ÷ .045"	4,5 m 15'	43115	1	
20	GM0277			white liner	1,2 ÷ 1,6 mm	.040" ÷ .1/16"	4,5 m 15'	44215	1	

	CODE			
5	BW0450		insulator	10
5	BW0451		front insulator	10
6	F16730		Trigger Bd	1

	CODE			
7	F16706		handle kit	1
7	F16707		handle spring	1
9	F16740		back box spring	1

STANDARD